

SPRING PUSH STANDARD AUR/1/S & DUR/2/S  
 IN PARALLEL FRAME POSITION  
 USING  $\phi 6\text{mm}$  TRANSDUCER WITH RADIAL CABLE OUTLET

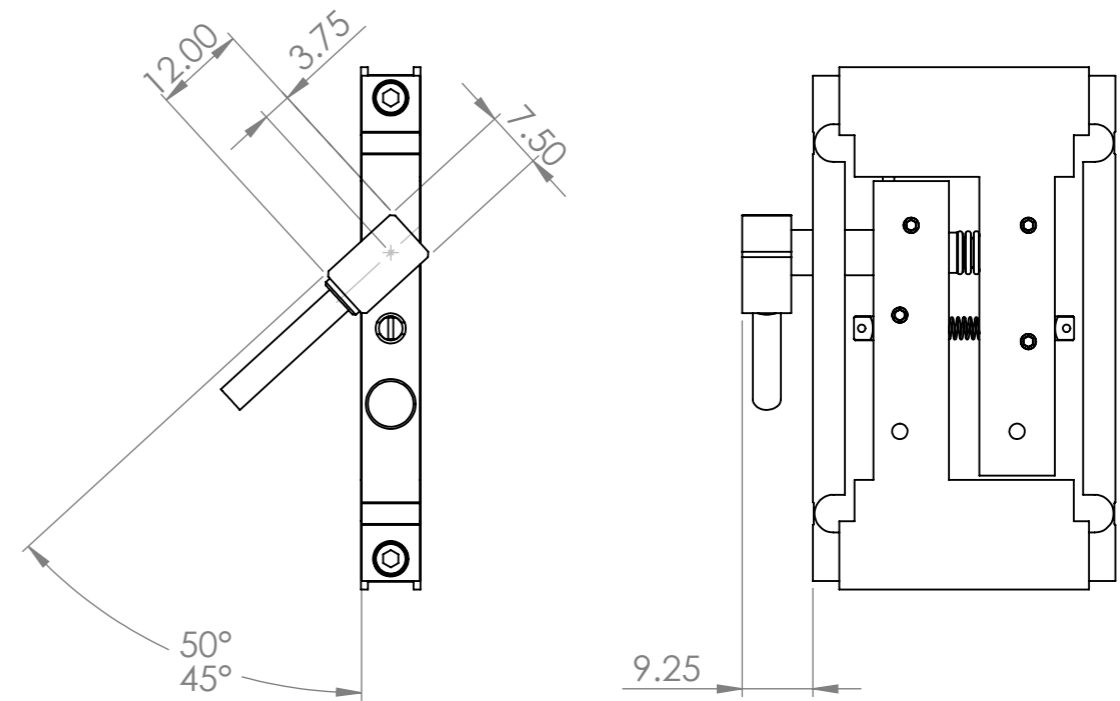

SPRING PUSH STANDARD AU/1/S & DU/2/S  
 IN PARALLEL FRAME POSITION  
 USING  $\phi 6\text{mm}$  TRANSDUCER WITH AXIAL CABLE OUTLET

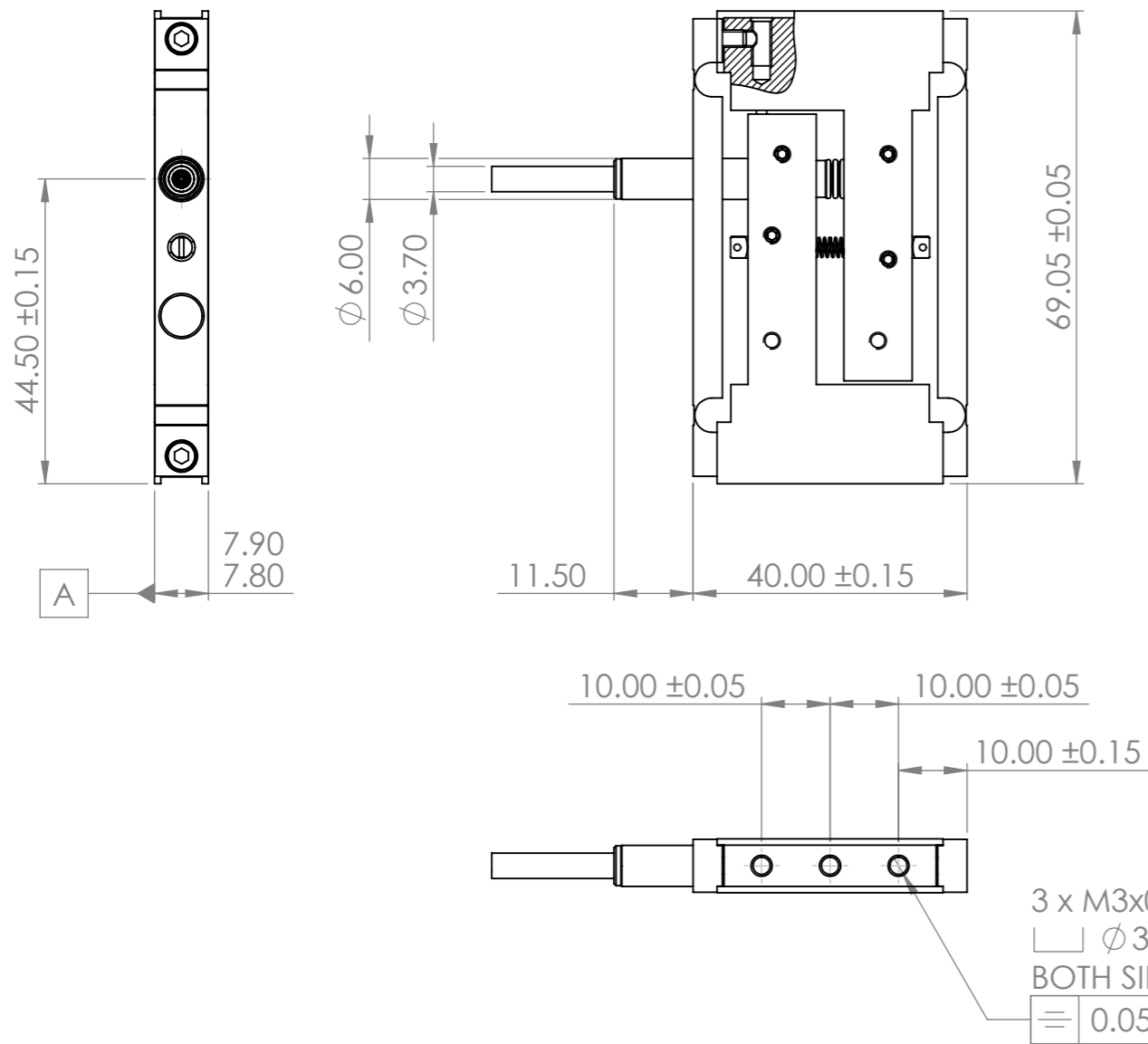

PNEUMATIC STANDARD AU/1/P & DU/2/P  
 IN PARALLEL FRAME POSITION  
 USING  $\phi 6\text{mm}$  TRANSDUCER WITH AXIAL CABLE OUTLET

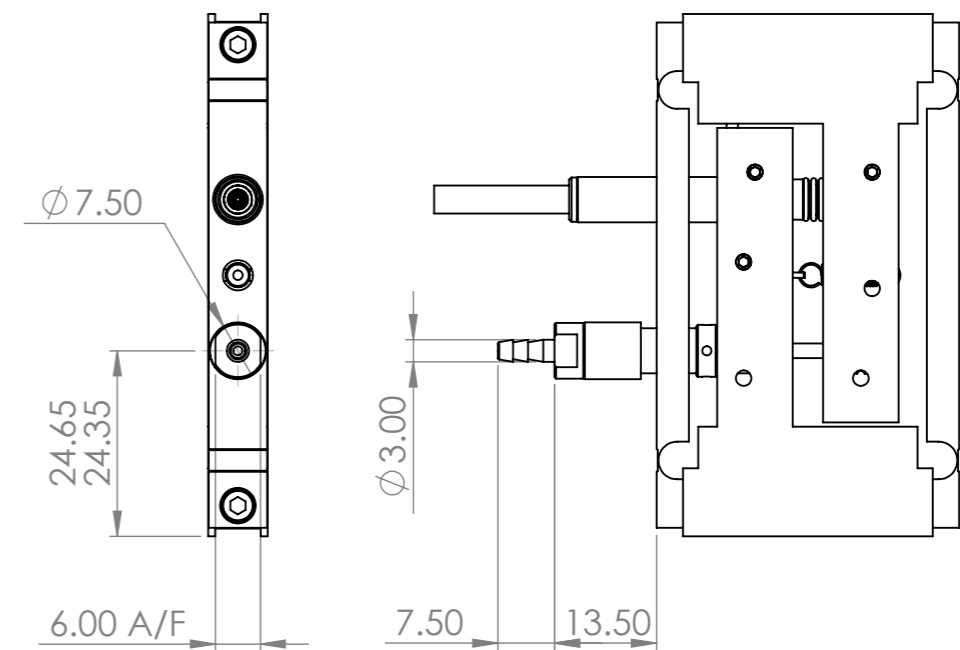

STEYNING WAY • BOGNOR REGIS • SUSSEX • ENGLAND • PO22 9ST

DRAWING NUMBER  
**540002-104**

TITLE  
**FLEXURE  
 AU/1 & DU/2**

E.D.C.R.  
 ISSUE

22757  
 2

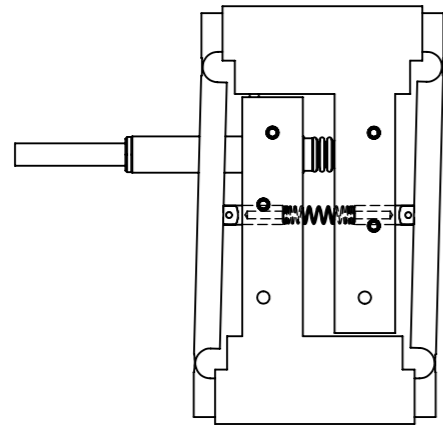

AU/1/S(H) OR DU/2/S  
STANDARD

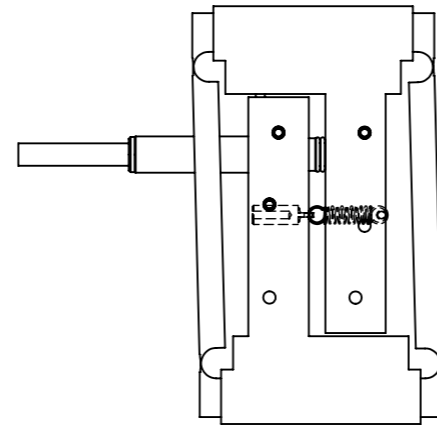

AU/1/R(H) OR DU/2/R  
REVERSED ACTION

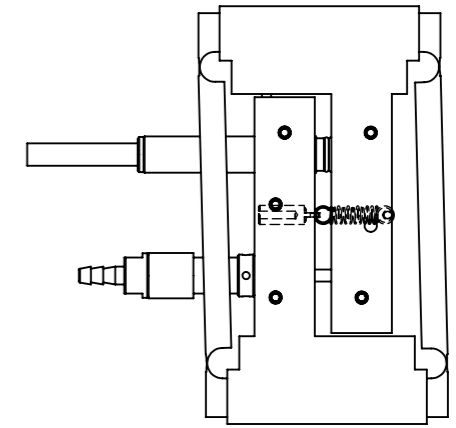

AU/1/P(H) OR DU/2/P  
STANDARD

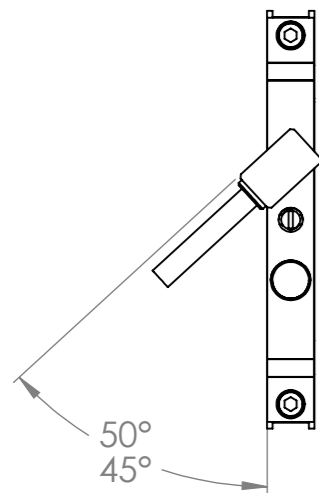

AUR/1/S(H) OR DUR/2/S  
STANDARD

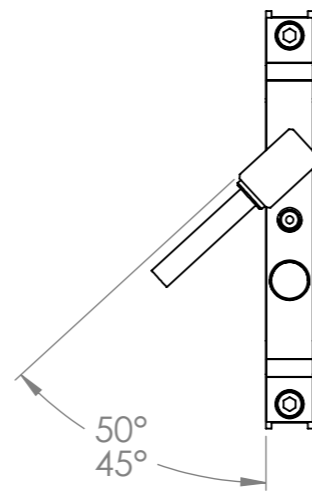

AUR/1/R(H) OR DUR/2/R  
REVERSED ACTION

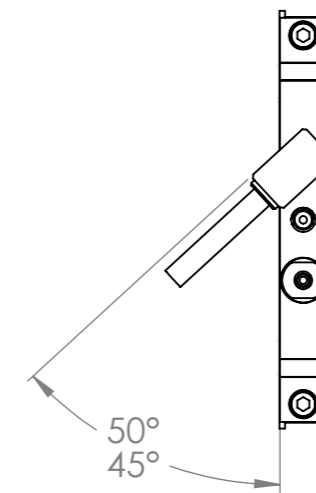

AUR/1/P(H) OR DUR/2/P  
STANDARD

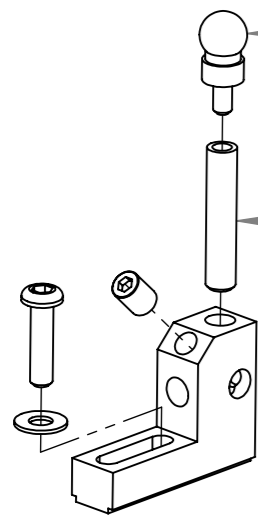

**TIPS**

008305-005 STANDARD  
VARIOUS TIPS AVAILABLE  
FOR DIFFERENT APPLICATIONS

**TOOL HOLDERS**

208221/20 RECOMMENDED  
208221/30  
208221/40  
208221/60

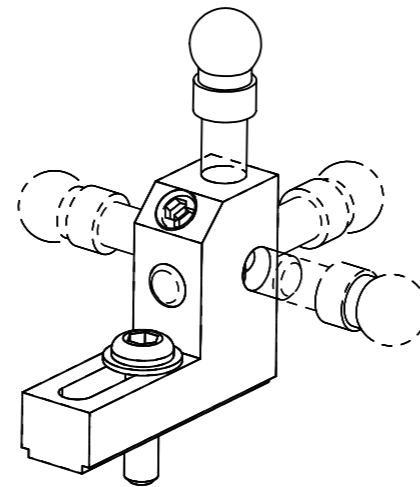

806274-SX TOOL HOLDER ASSY  
AU/1 & DU/2 -  $\phi$ 4mm  
TIP & TOOL HOLDER SHOWN FOR ALTERNATIVE POSITIONS ONLY

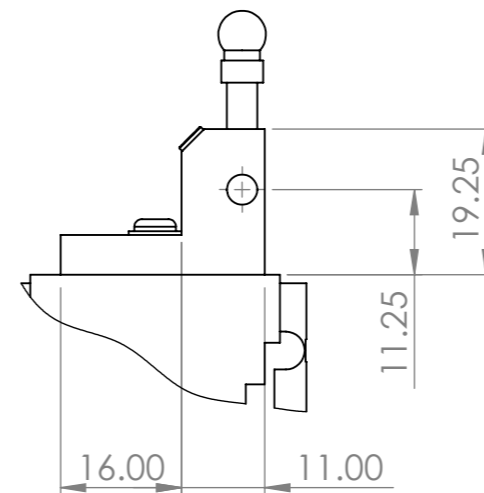

TOOL HOLDER - ASSEMBLED

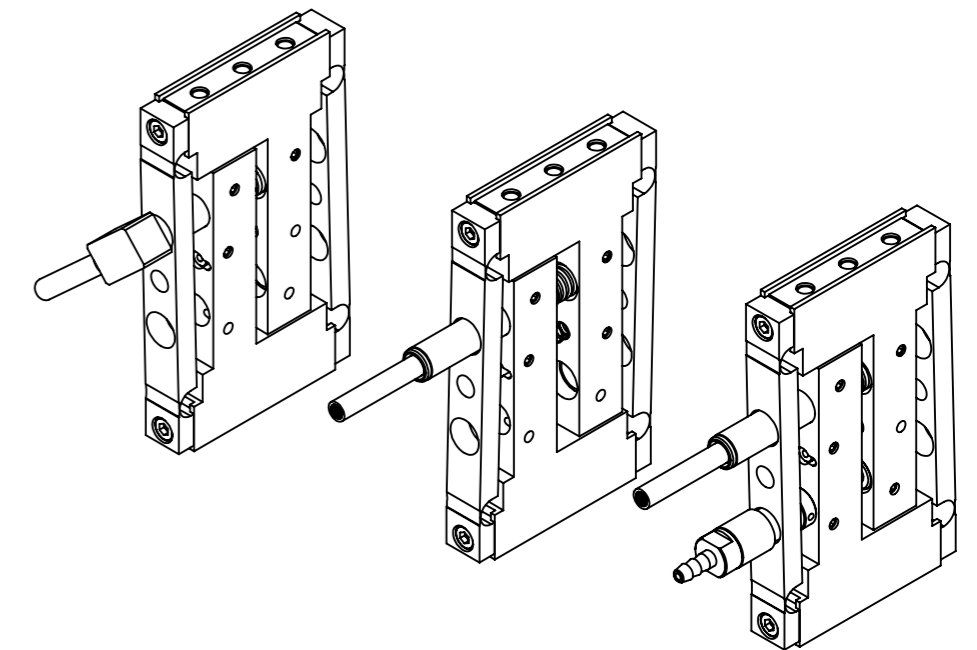

STEYNING WAY • BOGNOR REGIS • SUSSEX • ENGLAND • PO22 9ST

DRAWING NUMBER

540002-104

TITLE

FLEXURE  
AU/1 & DU/2

E.D.C.R.

22757

ISSUE

2

SOLARTRON PURSUES A POLICY OF CONTINUOUS DEVELOPMENT. SPECIFICATIONS IN THIS DOCUMENT MAY THEREFORE BE CHANGED WITHOUT NOTICE. DIMENSIONS ARE NOMINAL AND SPECIFIED IN MILLIMETRES